

# Samaritan Pacific Communities Hospital Campus Map

Revised: March 2019

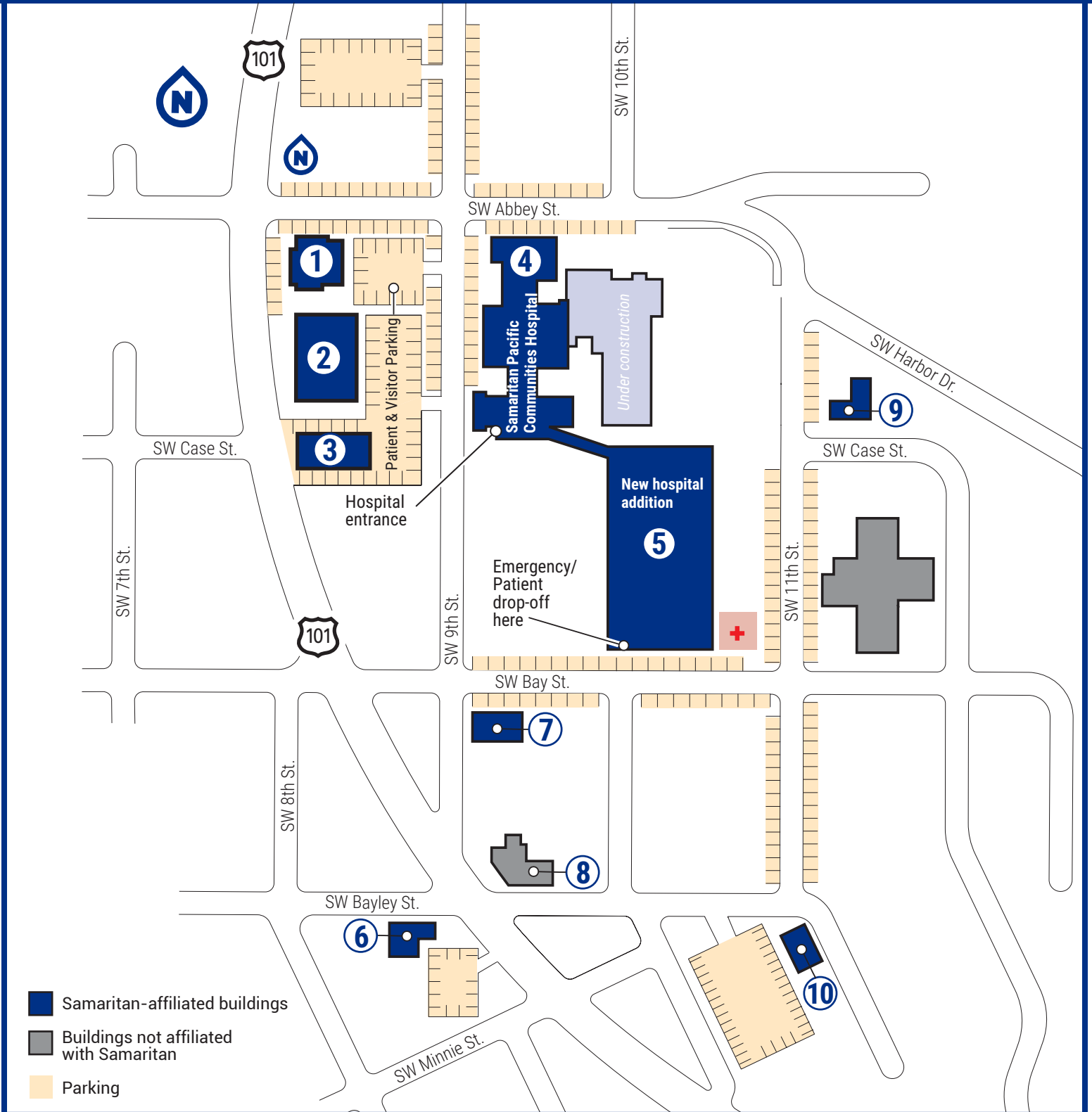

Samaritan  
Pacific Communities  
Hospital

930 SW Abbey St., Newport, Oregon  
541-265-2244

# Departments and health care clinics on the Samaritan Pacific Communities Hospital campus

**① Samaritan Medical Supplies**  
705 SW Coast Hwy. | 541-574-7200  
*A provider-based clinic*

**② Center for Health Education**  
740 SW 9th St. | 541-574-4954  
*A department of the hospital*

**③ Samaritan Walk-in Clinic**  
740 SW 9th St. | 541-574-4860  
*A provider-based clinic*

## **Samaritan Occupational Medicine – Newport**

740 SW 9th St. | 541-574-4675

- Beverly Hall, FNP
- Charles Pedersen, MD

**④ Samaritan Pacific Communities Hospital**  
930 SW Abbey St.

- Billing
- Cafeteria
- Cardiopulmonary
- Cardio Rehabilitation
- Diabetes Education
- Laboratory
- Medical Records
- Wound Care

**⑤ Samaritan Pacific Communities Hospital, new addition**  
930 SW Abbey St.

### **First Floor**

- Surgery
- Diagnostic Imaging
- Emergency Department

### **Second Floor | Clinics**

#### **Check-in 1: Samaritan Health Center – Newport**

- Cardiology
- Endocrinology
- Family Medicine
  - Rachel Bailey, DO
  - Terry Jones, PA-C
  - Kristina Uehlin, PA-C
- Internal Medicine
  - Hannah Balduff, PA-C
  - David Long, MD
- Pediatrics
  - Sean Rash, MD
  - Linell Wood, PA-C
- Psychology, Psychiatry and Mental Health
  - Charles Romero, MD
  - Marc Taylor, PhD

#### **Check-in 2: Provider-based clinics**

- PCH Anticoagulation
- Samaritan Hematology & Oncology Consultants – Newport
  - Keith Goldstein, MD
  - David Hufnagel, DO
  - Jennifer Rainey, PA-C

- Samaritan Women's Health Center – Newport
  - Lindsay Kern, MD
  - J.K. Shumate, MD
  - John Wichert, MD, FACOG
  - Brenda Woods, CNM

#### **Check-in 3: Provider-based clinics**

- Samaritan Kidney Specialists – Newport
  - Anthony DeMory, MD
  - Deanne Leonard, MD
  - Vyacheslav Melnikov, MD
  - Ridhmi Rajapakse, MD
- Samaritan Orthopedics & Podiatry – Newport
  - Gerald Butler, MD
  - Andrew Evans, DPM
  - John Nightingale, PA-C
  - Bruce Watanabe, MD
  - David Zarkou, DPM
- Samaritan Surgical Associates – Newport
  - Kelly Hewitt, MD
  - David Larson, MD
  - Douglas Wilson, MD
- Samaritan Urology Clinic – Newport
  - Robert Laciak, MD
  - Layron Long, MD

#### **Third Floor | Patient Rooms**

- Acute Care Unit
- Birthing Center
- Intensive Care Unit

**⑥ Ear, Nose and Throat (ENT) & Allergy Clinic**

*An independent provider*

1010 SW Coast Hwy., Suite 201 | 541-967-0331

**⑦ Pacific Eye Associates**

*An independent provider*

904 SW Bay St. | 541-265-6582

**Silver Falls Dermatology**

*An independent provider*

904 SW Bay St. | 866-599-3376

**⑧ Fresenius Kidney Care**

*An independent provider*

957 SW Coast Hwy | 800-881-5101

**⑨ Bayview Building**

**Samaritan Evergreen Hospice | 541-574-1811**  
**PCHD Foundation | 541-574-4745**

**⑩ Samaritan Physical Rehabilitation Specialists – Newport**

*A department of the hospital*

**Physical, occupational and speech therapies**

1111 SW 10th St., second floor | 541-574-1823

**The Corvallis Clinic – Sleep Medicine**

*An independent provider*

1111 SW 10th St. | 541-768-6930

**SamFit**

1111 SW 10th St. | 541-574-7300

# Samaritan Pacific Communities Hospital

## Services by Floor

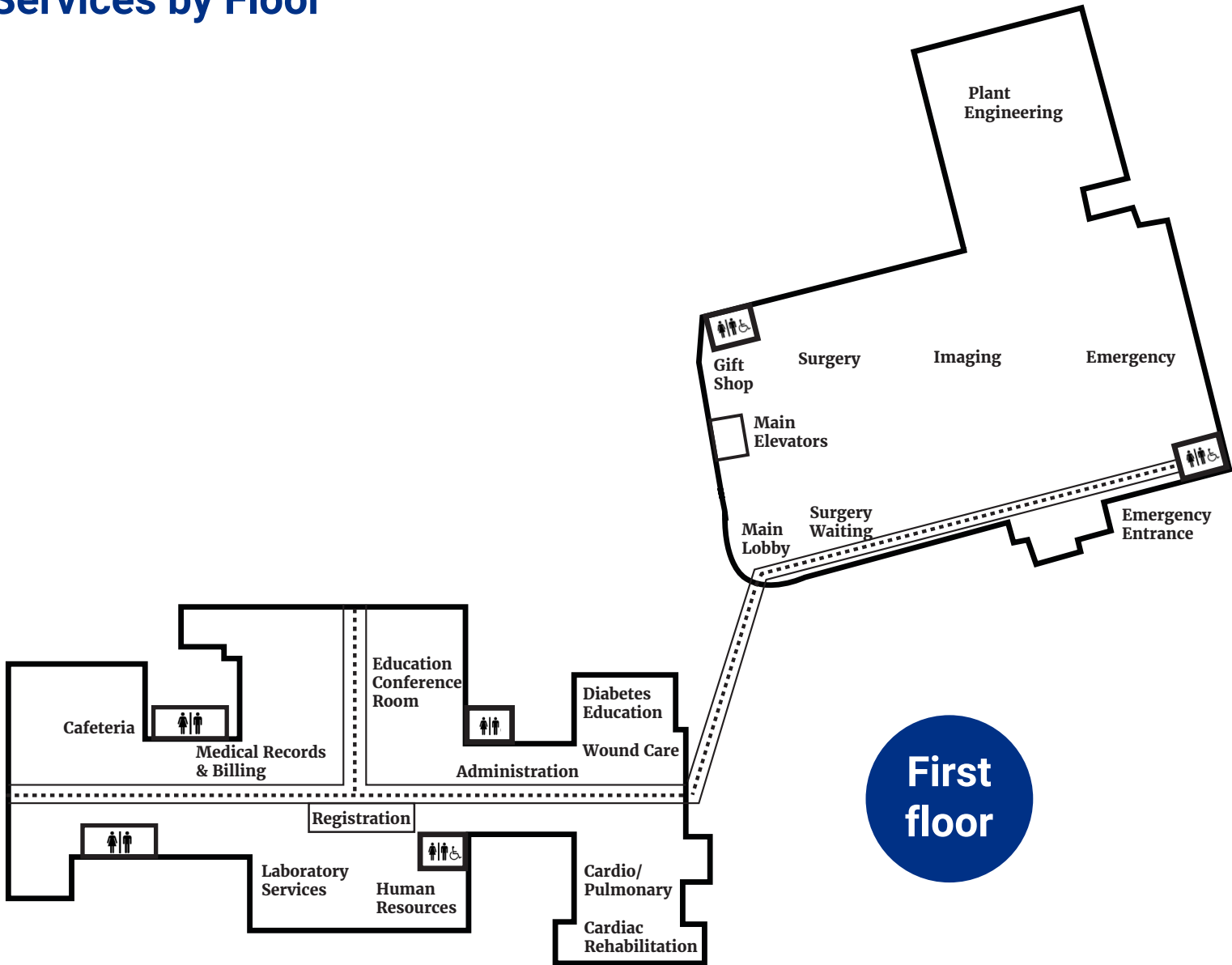

# Samaritan Pacific Communities Hospital

## Services by Floor

### Second floor

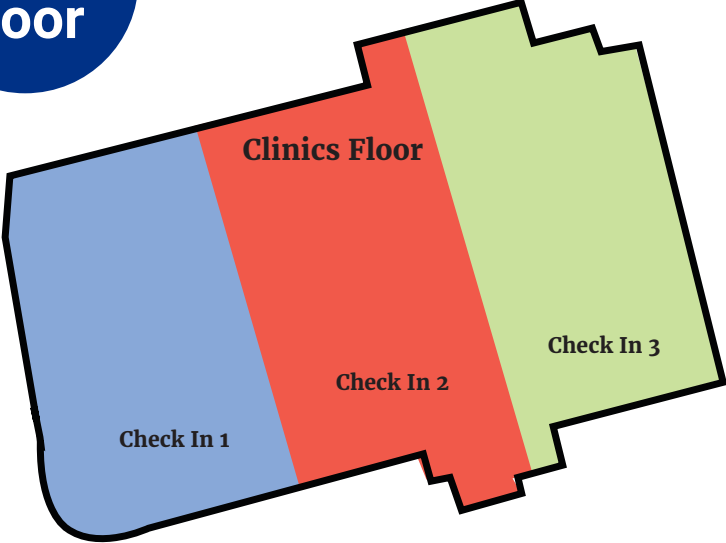

See detail on page two

### Third floor

